

Overview

Everest helps you managing your CAD data by making it easy and fast to deal with these four usually cumbersome tasks of data management: searching for CAD data, navigating through design documents, maintaining revisions of a document and comparing different versions of a document. This document describes the features of Everest and how they address each of these tasks.

Searching CAD data

Everest Search is based on a unique indexing technology the makes any data in your documents accessible almost instantly. Existing documents are indexed as part of Everest one time initialization, then the index is updated each time you modify, create or delete a design document so it is always accurate. All relevant properties of drawings are indexed, which includes layer and block names, text objects, text styles, dimension styles, hyperlinks, xdata, xrecords and many more.

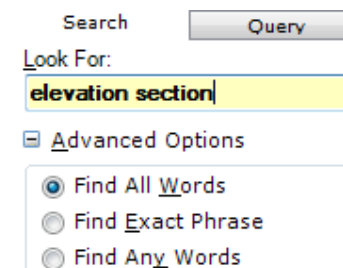

Simple search. The simple search looks for any data drawings regardless of its type. You may influence the way the documents are matched by requiring all the words of the searched sentence to be present, or only one of the words, or require that the exact searched sentence is matched exactly.

Additionally you may narrow the search by looking only in drawings belonging to a specific folder location. You can even narrow the search further by making a new search within the results of the previous search.

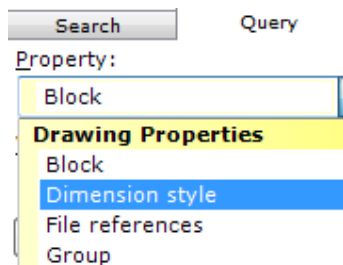

Query. The query works in a similar way as the simple search, but focuses on a specific property of your choice. When you know what type of property the searched text belongs to, use query to get more accurate results for your search.

Queries can also be filtered by folder location. And as for the simple search, you can query within the results of a previous query to further narrow down your result set.

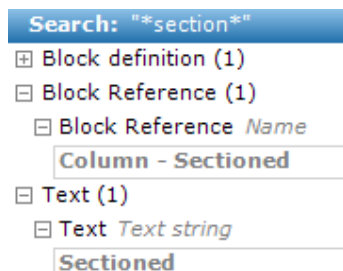

Locating matching data inside drawings. Everest goes beyond merely returning a list of drawings files matching your search or query. Open any drawing by search or query in AutoCAD and navigate through the matching data inside this drawing using Everest's file results list. Everest will zoom to and to highlight any data selected, allowing you to locate precisely any data found.

Navigating through your documents

Everest introduces the virtual desktop, a much superior way to navigate through and locate your documents than Windows Explorer. The virtual desktop, an abstraction above the file system, shows your documents in a way that makes them much more accessible. With Everest you can browse, locate and open your documents quicker than ever without leaving AutoCAD.

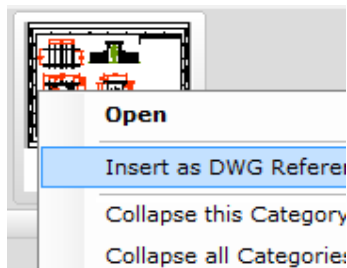
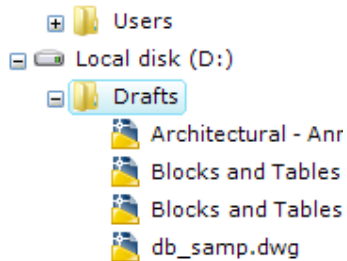
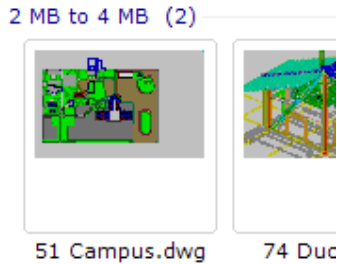

Categorized document list. Probably the most innovative aspect of the virtual desktop, this list groups together all the documents of your system regardless their folder location into one unique view organized by a criteria of your choice. With this view, you don't need to know the location of a document to spot it quickly. Know the name of the document? Sort the list by name and locate it immediately. Remember approximately when you last modified it? Sort the list by date and find it equally fast. No need to browse folders anymore.

Filtered folder view. If you like a view organized by folders better, Everest provide the same tree-structured representation of your file system as Windows Explorer's, but improves it by letting you filter it by document type. If you are only interested in drawings at the moment, Everest's folder view displays only the folders actually containing drawings. Because the folder tree is much smaller and displaying only documents you want to see, navigating it becomes quicker and easier.

Locate then open, insert and more... The virtual desktop helps you locate your documents quickly, and when a document is located you can perform a host of action on it, most commonly open it in AutoCAD to view it or work on it, but also insert the document as an external reference if it is a drawing, as an image reference if it is a picture, as a DWF underlay, as an OLE link and more.

Managing revisions of your documents

A document evolves during its lifetime and it is extremely useful to be able to track the history of changes the document went through. A revision represents the state of the document at a point in time. Everest lets you create a new revision of a document with a single click, and then manage the history of revisions for this document.

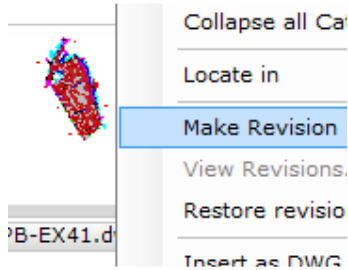

Create a revision with a single click. No need for copying and renaming files anymore to create a revision of a document. Select the revision command, enter a comment to identify this revision, and Everest takes care of the rest.

Revision	Comments
6	Dimensioned paths
5	Modified general c
4	Added river route
3	Changed pipe elen
2	New Layer 'Flood c
1	Initial revision

Managing your revisions made easy The history of revisions lets you keep track of the changes over time for this document. With a single action from the revision dialog, view the state of a past revision in AutoCAD, view the exact changes between two revisions, or restore to current state of the document to a past revision to get rid of recent unwanted changes.

Although Everest primarily works with AutoCAD drawings, you can also create revisions of other type of documents that are relevant to your designs, such as text files, images, or Microsoft Office documents.

Comparing documents visually

Maintaining the revision history of your documents is a good step toward tracking their evolutions, but Everest goes much beyond by letting you see graphically the differences between two revisions of your design documents. The visual comparison feature creates an AutoCAD drawing representing the differences between two drawings, showing each added, deleted or modified element using a customizable color coding. It also presents you with an interactive detailed report of all the changes, including for each modified object the value of all the properties that have changed.

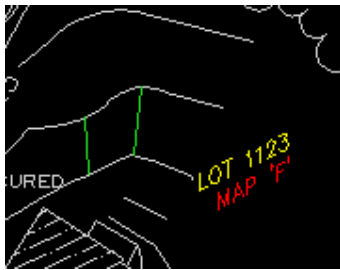

Graphical view of the differences. See within an AutoCAD editor window what has changed inside a drawing. Added, deleted, modified and unchanged elements appear in different colors. Older and newer version of modified objects can even be displayed in the same view to visually see the changes! You can even filter the graphical view to only show the type of difference you are interested in.

<input checked="" type="checkbox"/> Deleted (3)	
<input type="checkbox"/> Block Reference (2)	
Block Reference	TRE
Block Reference	TRE
<input type="checkbox"/> Text (1)	
Text	E6A
<input checked="" type="checkbox"/> Added (2)	
<input type="checkbox"/> Line (2)	

Interactive detailed difference report

The detailed report shows all the differences for both graphical and non-graphical objects. For modified objects, the report display the older and newer value for each modified property in each object. Select a graphical object in the report, whether it was added, deleted or modified, and Everest zooms to it and highlights it in the graphical view, making it easy to locate each particular change.

Because you can create revisions for other type of documents than drawings, Everest lets you compare revisions of those documents as well. Compare different versions of text files, images and other types of document from the revision dialog. Drawing comparison is built-in Everest, but for any other document type Everest let you use the comparison program of your choice.